

ECO	REV	3	DESCRIPTION	1	DATE
N/A	A		INITIAL RELEASE DRAWING		08/10/2011

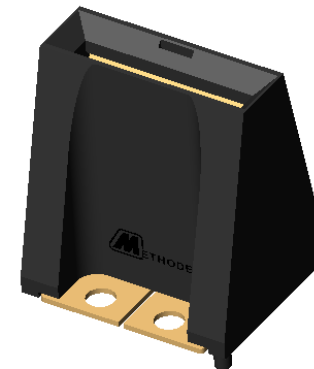
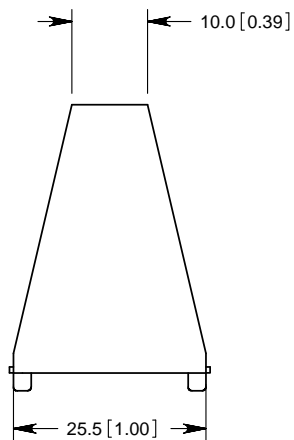
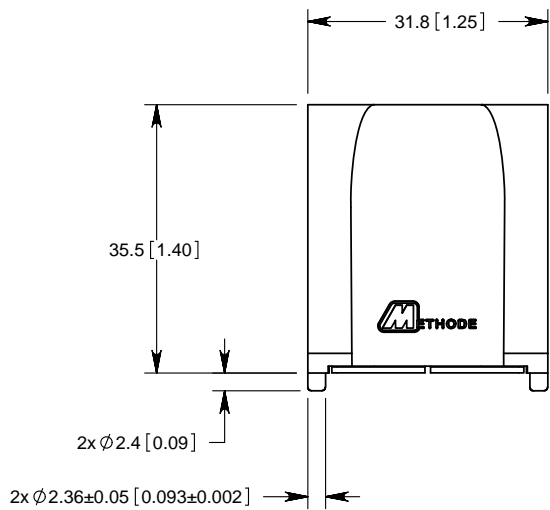

**- MCC CONNECTOR -
PN: 5301-07134-00105**

NOTES: UNLESS OTHERWISE SPECIFIED

1. CONNECTOR NAMES AND PART NUMBERS:

NAME: MCC SOCKET CONNECTOR, BUS MOUNT
SIZE 25.4 x 3.1 MM THICK MATING BLADE
PART NUMBER: 5301-07134-00105

2. MATERIALS:

INSULATOR: THERMOPLASTIC, UL 94 V-0
CONTACTS: COPPER ALLOY
CONTACT HOLDERS: COPPER ALLOY

3. FINISHES:

CONTACTS: GOLD PLATING OVER NICKEL UNDER PLATING
CONTACT HOLDERS: GOLD PLATING OVER NICKEL UNDER PLATING

4. REFERENCE DIMENSIONS IN PARENTHESIS (.XXX) ARE WITHOUT TOLERANCE AND USED FOR INFORMATION ONLY.

5. OPERATIONAL CONDITIONS

- * CONNECTOR LEAD-IN GATHERING OF 2.5 MM [.10 INCH].
- * RELIABLE MATE DEPTH (SEE SHEET 2).
- * TYPICAL CONNECTOR MATING FORCES OF 86 N [20 LBF].

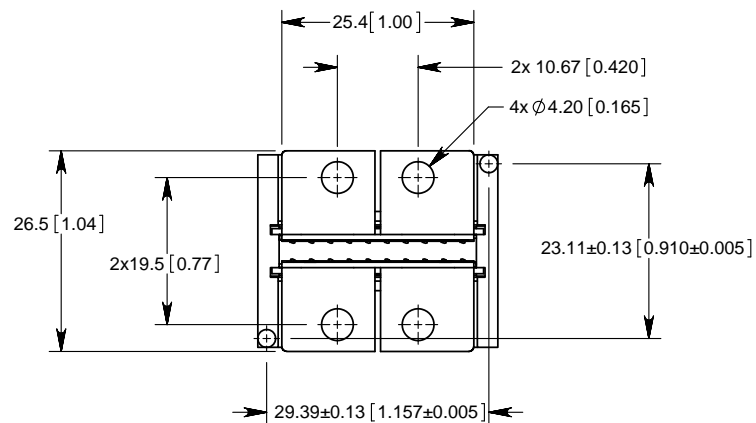

CONNECTOR PART NUMBER LISTED IN NOTE 1 DRAWING NUMBER BELOW IN TITLE BLOCK		
METHODE ELECTRONICS, INC. POWER SOLUTIONS GROUP 1750 Junction Avenue, San Jose, CA 95112 (408) 453-9500		
TITLE: USER DRAWING, BUS CONNECTOR MCC 3.1 MM BLADE BUS MOUNTED		
SIZE	DRAWING NUMBER:	REV
C	C5301-07134-00105	A
SCALE: 2:1	FILENAME: 5301-07134-00105	SHEET 1 OF 2

 THIRD ANGLE PROJECTION UNLESS OTHERWISE SPECIFIED DIMENSIONS ARE IN MILLIMETERS TOLERANCES ARE: DECIMALS ANGLES X.X ± 0.2 ± 2.0 X.XX ± 0.08 X.XXX ± 0.013 SURFACE FINISH: N/A	NAME	DATE	
	ORIG:	R. Larsen	03/03/2011
	ENGR:	R. Larsen	03/03/2011
	CHECKED:	H. Han	03/03/2011
PROPRIETARY AND CONFIDENTIAL NOTICE ALL INFORMATION IN THIS DRAWING IS CONFIDENTIAL AND PROPRIETARY INFORMATION AND IS NOT TO BE DISTRIBUTED, COPIED, OR SHARED EXCEPT WITH PRIOR WRITTEN APPROVAL OF METHODE ELECTRONICS, INC. POWER SOLUTIONS GROUP.			

ECO	REV	DESCRIPTION	DATE
N/A	A	INITIAL RELEASE DRAWING	08/10/2011

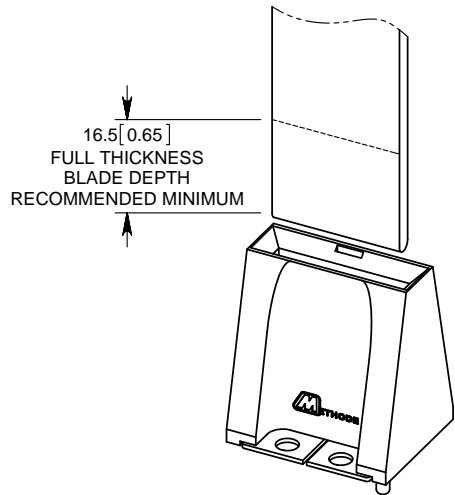

RELIABLE MATING DEPTH



MOUNTED CONNECTOR

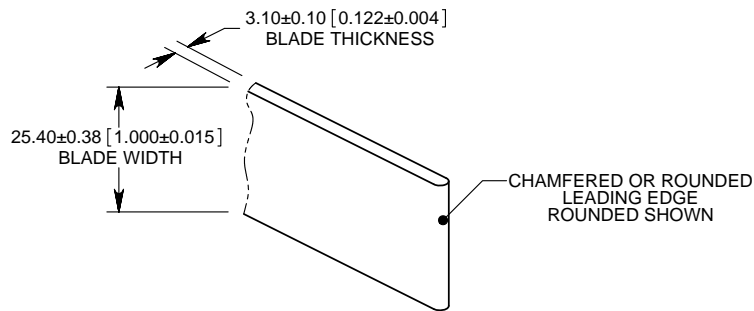

RECOMMENDED BLADE DIMENSIONS

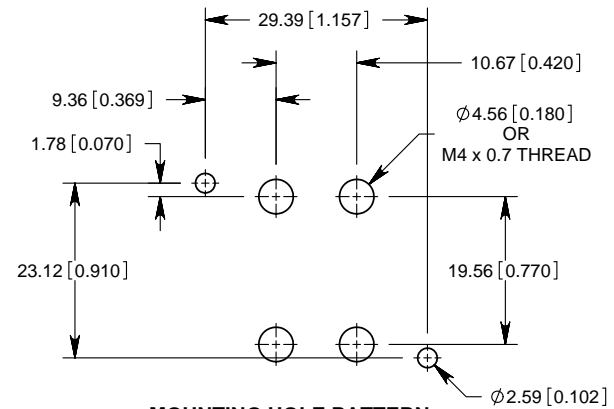

MOUNTING HOLE PATTERN

THIRD ANGLE PROJECTION		NAME	DATE	METHODE ELECTRONICS, INC. POWER SOLUTIONS GROUP		
TOLERANCES UNLESS OTHERWISE SPECIFIED DIMENSIONS ARE IN MILLIMETERS TOLERANCES ARE: DECIMALS ANGLES X.X ± 0.2 ± 2.0 X.XX ± 0.08 X.XXX ± 0.013 SURFACE FINISH: N/A		ORIG: R. Larsen	03/03/2011	1750 Junction Avenue, San Jose, CA 95112 (408) 453-9500 TITLE: USER DRAWING, BUS CONNECTOR MCC 3.1 MM BLADE BUS MOUNTED		
		ENGR: R. Larsen	03/03/2011			
		CHECKED: H. Han	03/03/2011			
		PROPRIETARY AND CONFIDENTIAL NOTICE ALL INFORMATION IN THIS DRAWING IS CONFIDENTIAL AND PROPRIETARY INFORMATION AND IS NOT TO BE DISTRIBUTED, COPIED, OR SHARED EXCEPT WITH PRIOR WRITTEN APPROVAL OF METHODE ELECTRONICS, INC. POWER SOLUTIONS GROUP.		SIZE C	DRAWING NUMBER: C5301-07134-00105	REV A
		SCALE: 1.5:1		FILENAME: 5301-07134-00105	SHEET 2 OF 2	